

Version 02
Updated 2010-11-06
14:46 Beijing Time



I E T F[®]



November 7-12, 2010

Hosted by:



清华大学

Tsinghua University



中国互联网络信息中心
CHINA INTERNET NETWORK INFORMATION CENTER



中国互联网协会
Internet Society of China

Table of Contents

Area Directors	2
Welcome from the IETF Chair	2
Key Meeting Contacts.....	3
Registration	3
Terminal Room.....	3
Badges and Dots	3
Food & Beverage Service	3
Lost and Found	3
Social Event.....	3
Message Board.....	3
Meeting Communication	4
Note Well	4
Floor Plans.....	5
Phrases for the Traveler	7
Shangri-La Hotel Area Map	7
Agenda of IETF 79, November 7-12, 2010	8
Thank You to IETF 79 Hosts and Sponsors.....	13
Next Meeting: IETF 80	14

Area Directors

Applications Area (APP)

- Alexey Melnikov, Isode Limited
- Peter Saint-Andre, Cisco

General Area (GEN)

- Russ Housley, Vigil Security, LLC

Internet Area (INT)

- Jari Arkko, Ericsson
- Ralph Droms, Cisco Systems

Operations and Management Area (OPS)

- Ronald Bonica, Juniper Networks
- Dan Romascanu, Avaya

Real-time Applications and Infrastructure Area (RAI)

- Gonzalo Camarillo, Ericsson
- Robert Sparks, Tekelec

Routing Area (RTG)

- Stewart Bryant, Cisco
- Adrian Farrel, Huawei Technologies

Security Area (SEC)

- Tim Polk, NIST
- Sean Turner, IECA, Inc.

Transport Area (TSV)

- Lars Eggert, Nokia Research Center
- David Harrington, HuaweiSymantec

Welcome from the IETF Chair

Welcome to IETF 79 in Beijing, China! I'm looking forward to many talented and enthusiastic people collaborating during the week.

Please extend your thanks to our meeting hosts: Tsinghua University, Internet Society of China, and China Internet Network Information Center. Also, thank our platinum sponsor Cisco. I am told that the social event on Tuesday evening will be wonderful. If you see someone with a green dot on their badge, please give them your personal thanks.



The Nominations Committee (NomCom) for 2010-2011 is working to select the leadership that will be seated in March 2011. For the first time, NomCom is using the open list process specified in RFC 5680. If you see someone with an orange dot on their badge, please make sure that the NomCom voting member hears your thoughts on the candidates.

First-time attendees will have a "New Attendee" badge banner. When you see someone with this banner, please make them feel welcome and answer their questions about the IETF culture.

At this meeting, a credential is needed to gain access to the IETF meeting wireless network. Your primary credential is your Registration ID, which can be found on the registration web page, in the confirmation email you received from the Secretariat, on your payment receipt, and the back of your IETF meeting badge. If for any reason you are uncomfortable using this personal Registration ID, there will be a large supply of completely anonymous Registration ID/Password pairs on slips of paper available at the help desk and registration desk. You will be asked to show an IETF meeting badge to get one to ensure that slips are provided only to registered meeting attendees.

I look forward to your participation this week, and I look forward to seeing you at IETF 80 in Prague, Czech Republic from 27 March 2011 to 1 April 2011.

Thanks for all you do for the Internet!

A handwritten signature in black ink that reads "Russ Housley". The signature is written in a cursive, flowing style. Below the signature, the name "Russ Housley" and the title "IETF Chair" are printed in a standard black font.

Russ Housley
IETF Chair

Key Meeting Contacts

Network Connectivity and Audio Streaming Issues: noc@ietf.org.

All other meeting issues: mtd@ietf.org.

Registration

Location: Valley Wing, Level 2

DAY/DATE	HOURS
Sunday	1100 – 1900
Monday	0800 – 1800
Tuesday	0800 – 1800
Wednesday	0800 – 1700
Thursday	0800 – 1700
Friday	0800 – 1100

Note: To request a hard copy receipt, please send an email to registrar@ietf.org. All requested hard copy receipts will be available for pick up at the registration desk starting at 0800 on Wednesday, November 10, 2010.

Terminal Room

The Terminal Room will be in the Lotus Room (Garden Wing Level 2). Your IETF name badge is required for entry and 24-hour access is available starting at 1600 Sunday, November 7 through 1500 Friday, November 12.

Badges and Dots

Please wear your badge at all times.

Dot Key:

Blue: Working Group & BOF Chairs
Red: IAB
Yellow: IESG
Purple: IAOC
Pink: IRSG
Green: Host
Orange: NomCom
Orange Banner: Press

First Time Attendees are offered a "New Attendee" badge banner. If you see attendees wearing such a banner, please make an effort to make them feel welcome and answer any questions they may have.

Food & Beverage Service

Sunday Welcome Reception

1700 – 1900 in the Valley Ballroom BC on Level 2.

Beverage and Snack Service:

Available in the Valley and Garden Ballroom Foyers.

Monday: 0800-0900 (beverage only)
1610-1630 (beverage & snack)
Tuesday: 0800-0900 (beverage only)
1500-1520 (beverage & snack)
Wednesday: 0800-0900 (beverage only)
1610-1630 (beverage & snack)
Thursday: 0800-0900 (beverage only)
1500-1520 (beverage & snack)
1720-1740 (beverage & snack)
Friday: 0800-0900 (beverage only)

* Breakfast buffet is included with your sleeping room if you are staying in one of the IETF hotels. Breakfast will not be provided at the meeting.

* Lunch and dinner are not provided.

Lost and Found

Please turn in all "found" items to the IETF Registration Desk, Valley Wing Level 2.

Social Event

Where: Capital Museum, China

Date: Tuesday, November 9, 2010

Time: 1800 - 2100

Hosts: Tsinghua University

For more information:

<http://www.ietf79.cn/show.php?contentid=20>

To register:

<https://www.ietf.org/registration/ietf79/eventticket.py>

Message Board

Located near the IETF Registration Desk:

The message board contains important information such as agenda changes, incoming phone messages and messages to other attendees. Please do not post resumes, job openings or solicitations of any kind.

Meeting Communication

<p><u>Troubleshooting</u></p> <p>When reporting problems, please be as specific as possible in your message and remember to include the room name.</p> <p>For network connectivity and audio streaming issues, please contact noc@ietf.org.</p> <p>For all other meeting issues, including A/V and environmental issues (e.g. noise, temperature), please contact mtd@ietf.org.</p>	<p><u>Audio Streaming</u></p> <p>Audio streaming during the meeting can be accessed at:</p> <p>http://videolab.uoregon.edu/events/ietf/ietf79.m3u</p> <p>Following the meeting, the audio archives will be housed on the IETF website at:</p> <p>http://www.ietf.org/audio/ietf79/</p>
<p><u>Jabber Rooms</u></p> <p>Jabber rooms are available for each session and use the name of the working group:</p> <p>[wg]@jabber.ietf.org</p> <p>Logging is automatically enabled in each room. The logs are located here: http://jabber.ietf.org/logs/</p> <p>For more information about Jabber, see http://www.jabber.org/</p>	<p><u>Meeting Mail Lists</u></p> <p><u>79ALL</u> Everyone who has registered for the meeting is subscribed to 79ALL. The list is reserved for official communication from the IETF Administrative Director (IAD) and the Secretariat. Attendees cannot send to this list.</p> <p><u>79ATTENDEES</u> This list is intended for community discussions during the meeting and all subscribers can send to this list. Subscribe and unsubscribe at www.ietf.org/mailman/listinfo/79attendees. This mailing list will expire 30 days after meeting.</p>

Note Well

Any submission to the IETF intended by the Contributor for publication as all or part of an IETF Internet-Draft or RFC and any statement made within the context of an IETF activity is considered an "IETF Contribution". Such statements include oral statements in IETF sessions, as well as written and electronic communications made at any time or place, which are addressed to:

- the IETF plenary session,
- any IETF working group or portion thereof,
- the IESG or any member thereof on behalf of the IESG,
- the IAB or any member thereof on behalf of the IAB,
- any IETF mailing list, including the IETF list itself, any working group or design team list, or any other list functioning under IETF auspices,
- the RFC Editor or the Internet-Drafts function

All IETF Contributions are subject to the rules of RFC 5378 and RFC 3979 (updated by RFC 4879).

Statements made outside of an IETF session, mailing list or other function, that are clearly not intended to be input to an IETF activity, group or function, are not IETF Contributions in the context of this notice. Please consult RFC 5378 and RFC 3979 for details.

A participant in any IETF activity is deemed to accept all IETF rules of process, as document in Best Current Practices RFCs and IESG Statements. A participant in any IETF activity acknowledges that written, audio and video records of meetings may be made and may be available to the public.

Floor Plans

Valley Wing
Level 2

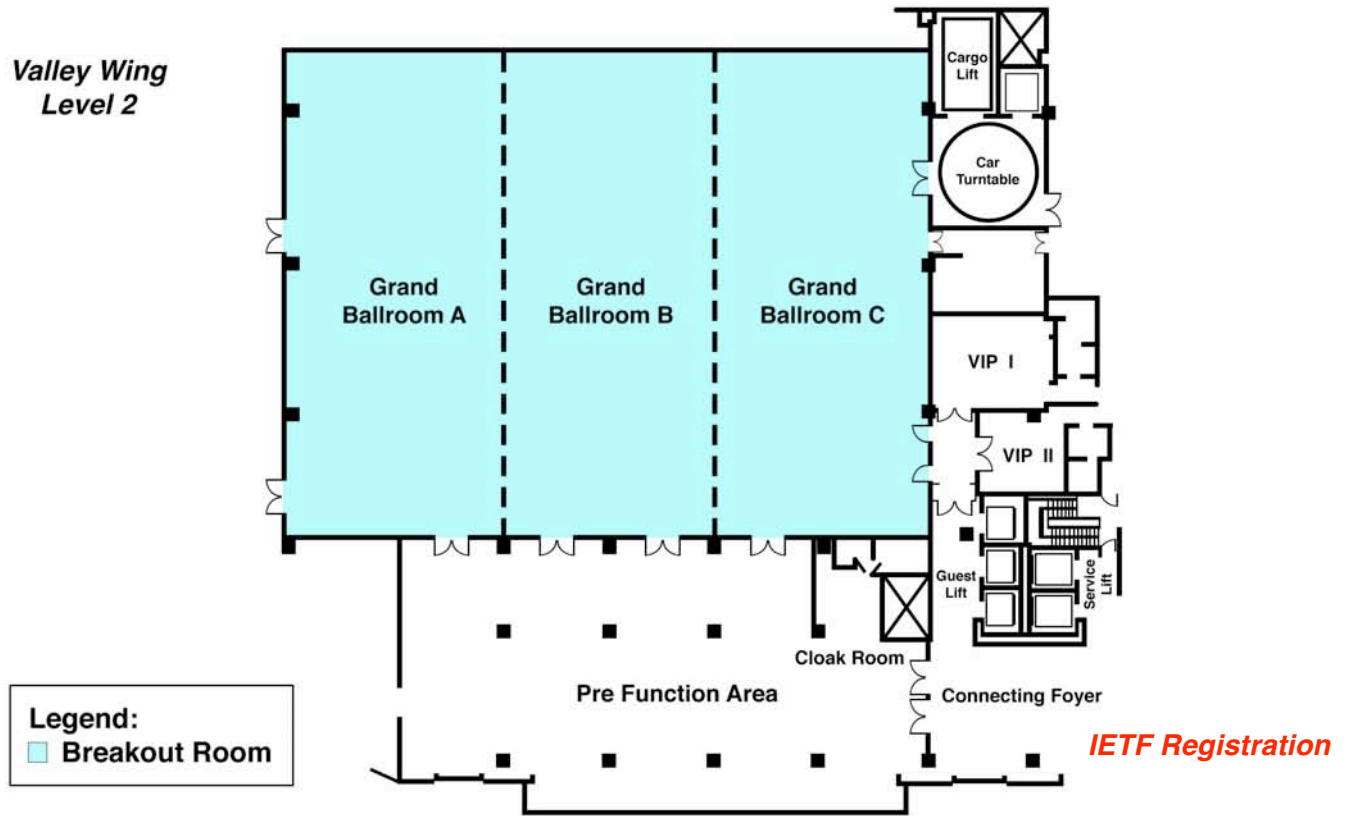

Valley Wing
Level 3

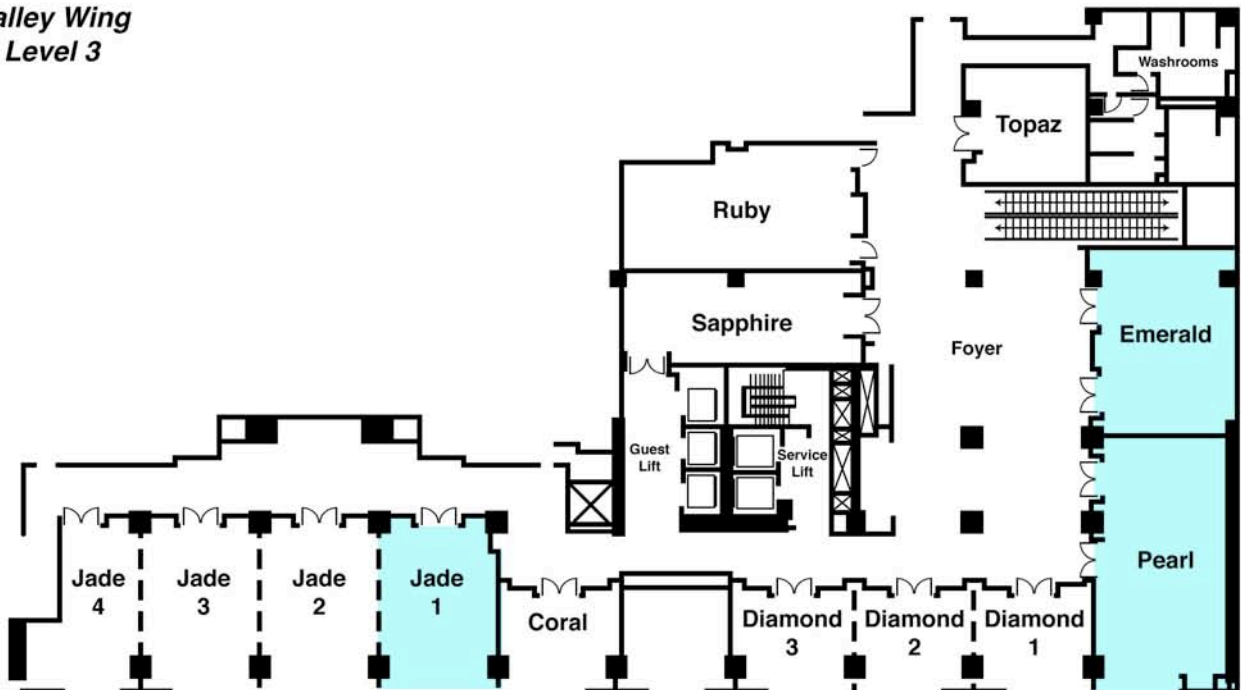

*Garden Wing
Level 1*

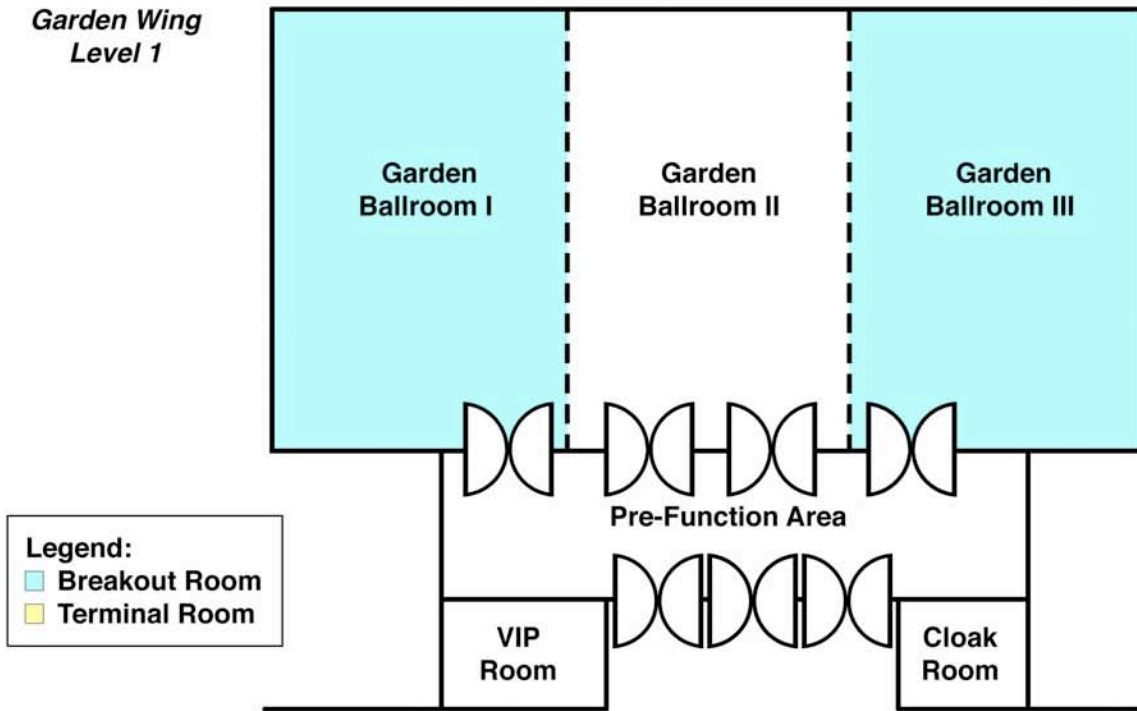

*Garden Wing
Level 2*

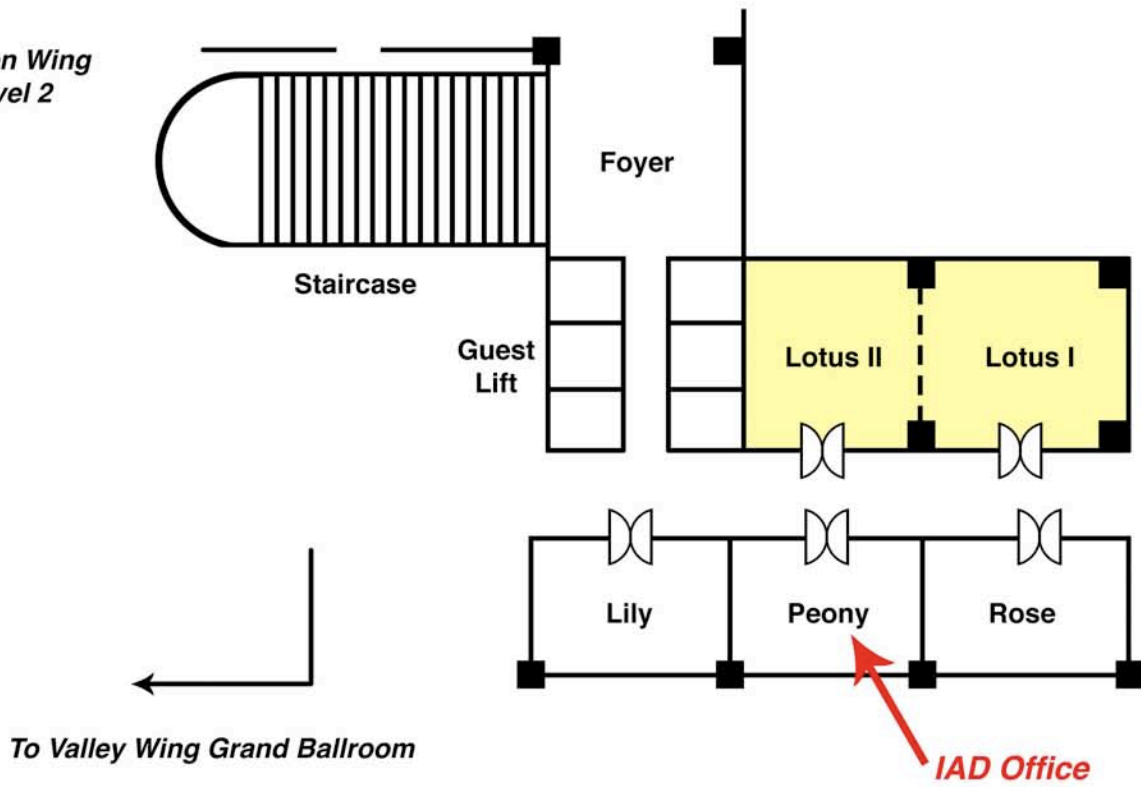

Phrases for the Traveler

Basic Communication		Getting Around	
Yes	Shì de	Take me to the airport, please.	Qing dao ji chang.
No	Méiyǒu	How do I get to ___?	Dao ___ zen me zou
Where is ___?	___ zai nar?	Emergencies	
How much?	Duo shao qian?	Please call a doctor.	Qing jiao yi sheng lai.
Ticket	piao	Call the police!	Kuai jiao jing cha lai
Where is the restroom?	Ce suo zai nar?	Help!	Lai ren ya!
Food	Shípǐn	Meeting People	
Drink (beverage)	Yin liao	Hello	Ni hao
Water	Shui	Goodbye	Zai jian
Thank you	Xie xie	My name is ___	Wo jiao ___.
You're welcome	Bu yong xie	What is your name?	Ni jiao shen me ming zi?
Excuse me/Pardon me/Sorry	Bu hao yi si	Pleased to meet you.	Ren shi nin hen gao xing.
		Do you speak English?	Hui shuo ying yu ma?

Shangri-La Hotel Area Map

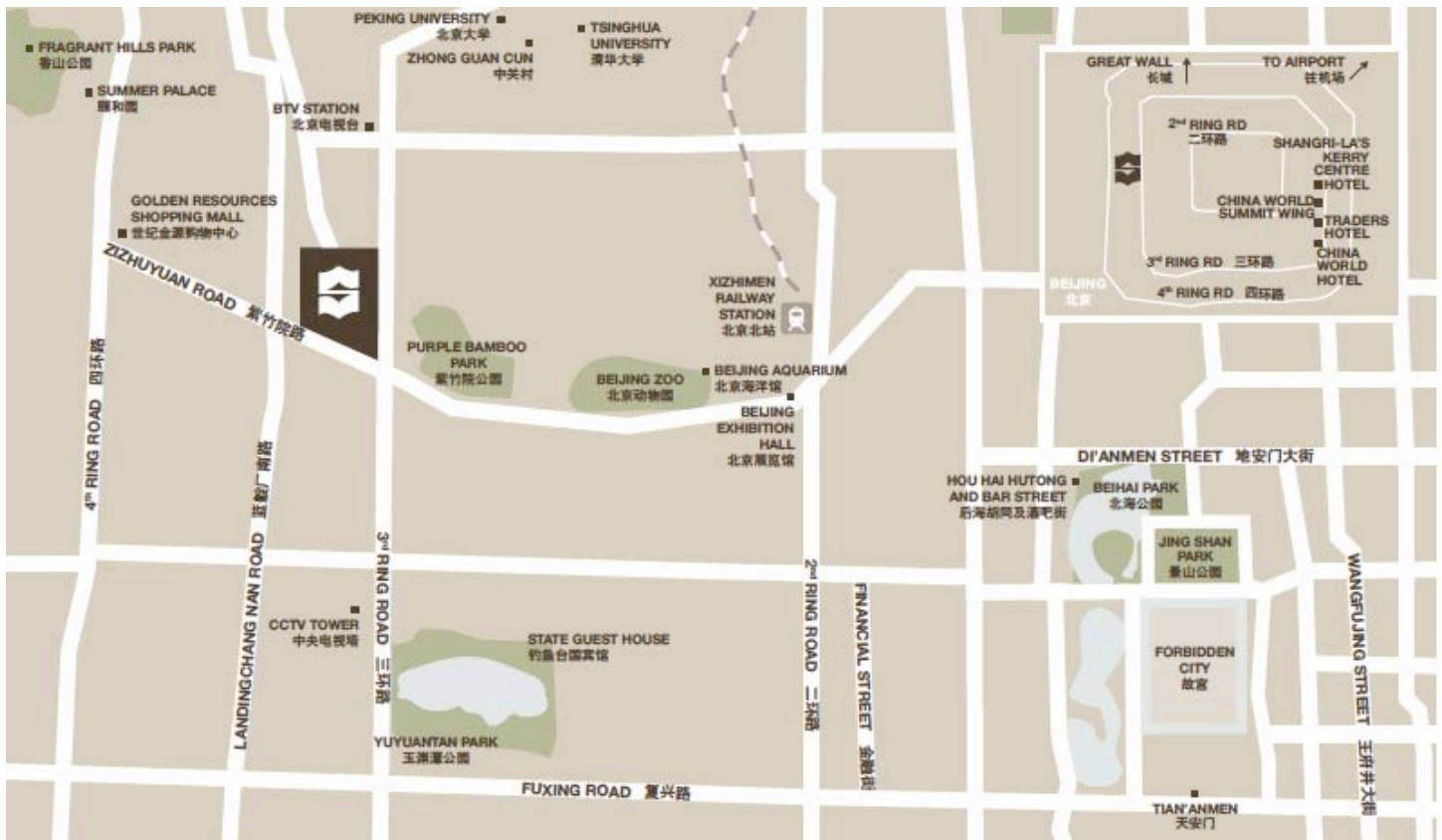

Shangri-La Hotel, Beijing
 29 Zizhuyuan Road
 Beijing 100089 China
 T: (86 10) 6841 2211
 F: (86 10) 6841 8002/3

北京香格里拉饭店
 中国北京市紫竹院路29号
 邮政编码100089
 电话: (86 10) 6841 2211
 传真: (86 10) 6841 8002/3

Agenda of IETF 79, November 7-12, 2010

Updated 2010-11-03 18:25:12 PDT
IETF agendas are subject to change, up to and during the meeting.

SATURDAY, November 6, 2010

0930-1700 Code Sprint – Lotus 1-2

SUNDAY, November 7, 2010

1100-1900 IETF Registration - Valley Ballroom Foyer
1000-1200 IEPG Meeting – Garden Ballroom 1
1300-1450 Newcomer's Training - Garden Ballroom 1
1300-1450 Security Tutorial - Garden Ballroom 3
1500-1650 Newcomer's Training (Mandarin) - Garden Ballroom 1
1500-1650 Document Lifecycle - Garden Ballroom 3
1500-1650 Routing, Bridging and Switching Tutorial - Valley Ballroom C
1700-1900 Welcome Reception - Valley Ballroom AB

- New additions to a meeting slot are marked in blue.
- All other agenda changes are marked in red.

MONDAY, November 8, 2010

0800-1800 IETF Registration - Valley Ballroom Foyer

0900-1130 Morning Session I

Garden Ballroom 1	APP	apparea	Applications Area Open Meeting
Valley Ballroom C	INT	mext	Mobility EXTensions for IPv6 WG
Valley Ballroom B	INT	softwire	Softwires WG
Emerald	INT	lisp	Locator/ID Separation Protocol WG
Pearl	RAI	p2psip	Peer-to-Peer Session Initiation Protocol WG
Valley Ballroom A	RTG	pwe3	Pseudowire Emulation Edge to Edge WG
Valley Ballroom A	RTG	mpls	Multiprotocol Label Switching WG – Moved to Monday afternoon session II 1510-1610
Jade 1	TSV	ippm	IP Performance Metrics WG
Garden Ballroom 3	TSV	nbs	Name-Based Sockets BOF

1130-1300 Break

1300-1500 Afternoon Session I

Jade 1	APP	precis	Preparation and Comparison of Internationalized Strings WG
Garden Ballroom 3	GEN	idtdspec	Review of Datatracker Specifications to Follow Internet-Draft Activities BOF
Valley Ballroom A	INT	trill	Transparent Interconnection of Lots of Links WG
Valley Ballroom C	INT	ancp	Access Node Control Protocol WG
Garden Ballroom 1	OPS	netconf	Network Configuration WG
Valley Ballroom B	RAI	avt	Audio/Video Transport WG
Pearl	RTG	pim	Protocol Independent Multicast WG
Valley Ballroom C	RTG	pwe3	Pseudowire Emulation Edge to Edge WG - Cancelled
Emerald	SEC	nea	Network Endpoint Assessment WG

1510-1610 Afternoon Session II

Emerald	APP	core	Constrained RESTful Environments WG
Garden Ballroom 3	IRTF	dtng	Delay-Tolerant Networking Research Group
Pearl	RAI	martini	Multiple AoR reachability Information Indication WG - Cancelled
Valley Ballroom C	RTG	mpls	Multiprotocol Label Switching WG
Valley Ballroom C	RTG	pwe3	Pseudowire Emulation Edge to Edge WG – Moved to Monday morning session I 0900-1130
Jade 1	SEC	msec	Multicast Security WG
Garden Ballroom 1	SEC	tls	Transport Layer Security WG - Cancelled
Valley Ballroom A	TSV	mptcp	Multipath TCP WG

1610-1630 Afternoon Beverage and Snack Break I - Valley Ballroom Foyer

1630-1930 Technical Plenary - Valley Ballroom ABC

1. Welcome (16:30)
2. IRTF Chair's Report - Aaron Falk
3. IAB Chair's Report - Olaf Kolkman
4. Technical Session (17:00): "IPv6 Operations and Transitional Issues " Presentations and panel discussion.
5. IAB Open Microphone Session (18:30)
6. RFC Editor Model version 2 (draft-kowack-rfc-editor-model-v2-00) (19:00)
 - Presentation by Glenn Kowack
 - Q&A and Discussion
7. Adjourn (19:30)

TUESDAY, November 9, 2010

0800-1800 IETF Registration - Valley Ballroom Foyer

0900-1130 Morning Session I

Garden Ballroom 3	APP	eai	Email Address Internationalization WG
Valley Ballroom B	INT	6man	IPv6 Maintenance WG
Garden Ballroom 1	IRTF	hiprg	Host Identity Protocol
Valley Ballroom A	OPS	opsarea	Operations & Management Area Open Meeting
Pearl	RAI	cuss	Call Control UII Service for SIP WG - Moved to Friday morning session I 0900-1130
Pearl	RAI	sipclf	SIP Common Log Format WG
Valley Ballroom C	RTG	ccamp	Common Control and Measurement Plane WG
Jade 1	SEC	kitten	Common Authentication Technology Next Generation WG
Emerald	TSV	nfsv4	Network File System Version 4 WG

1130-1300 Break

1300-1500 Afternoon Session I

Valley Ballroom B	APP	websec	Web Security WG
Garden Ballroom 3	INT	multimob	Multicast Mobility WG
Valley Ballroom A	OPS	netmod	NETCONF Data Modeling Language WG
Valley Ballroom C	RAI	codec	Internet Wideband Audio Codec WG
Emerald	RTG	forces	Forwarding and Control Element Separation WG
Garden Ballroom 1	RTG	l3vpn	Layer 3 Virtual Private Networks WG
Jade 1	SEC	hokey	Handover Keying WG
Pearl	TSV	ledbat	Low Extra Delay Background Transport WG

1500-1520 Afternoon Beverage and Snack Break I - Valley Ballroom Foyer

1520-1700 Afternoon Session II

Jade 1	APP	iri	Internationalized Resource Identifiers WG
Valley Ballroom A	INT	6lowpan	IPv6 over Low power WPAN WG
Emerald	INT	netext	Network-Based Mobility Extensions WG
Valley Ballroom B	INT	savi	Source Address Validation Improvements WG
Garden Ballroom 3	RAI	ecrit	Emergency Context Resolution with Internet Technologies WG
Valley Ballroom C	RTG	rtgarea	Routing Area Open Meeting
Pearl	SEC	scap	Synergy of SCAP Program and IETF Activities BOF
Garden Ballroom 1	TSV	pcn	Congestion and Pre-Congestion Notification WG - Cancelled

1710-1810 Afternoon Session III

Jade 1	APP	iri	Internationalized Resource Identifiers WG
Valley Ballroom A	INT	6lowpan	IPv6 over Low power WPAN WG
Emerald	INT	netext	Network-Based Mobility Extensions WG
Valley Ballroom B	INT	savi	Source Address Validation Improvements WG
Garden Ballroom 3	RAI	ecrit	Emergency Context Resolution with Internet Technologies WG
Valley Ballroom C	RTG	rtgarea	Routing Area Open Meeting
Pearl	SEC	scap	Synergy of SCAP Program and IETF Activities BOF
Garden Ballroom 1	TSV	tsvarea	Transport Area Open Meeting

WEDNESDAY, November 10, 2010

0800-1700 IETF Registration - Valley Ballroom Foyer

0900-1130 Morning Session I

Emerald	APP	core	Constrained RESTful Environments WG
Garden Ballroom 1	INT	tictoc	Timing over IP Connection and Transfer of Clock WG
Jade 1	OPS	ipfix	IP Flow Information Export WG
Valley Ballroom C	OPS	v6ops	IPv6 Operations WG
Valley Ballroom B	RAI	geopriv	Geographic Location/Privacy WG - Moved to Friday morning session I 0900-1130
Valley Ballroom B	RAI	drinks	Data for Reachability of Inter/tra Network SIP WG
Garden Ballroom 3	RTG	ospf	Open Shortest Path First IGP WG
Pearl	SEC	pkix	Public-Key Infrastructure (X.509) WG
Valley Ballroom A	TSV	tsvwg	Transport Area Working Group WG

1130-1300 Break

1300-1500 Afternoon Session I

Valley Ballroom B	APP	alto	Application-Layer Traffic Optimization WG
Jade 1	INT	autoconf	Ad-Hoc Network Autoconfiguration WG
Valley Ballroom A	INT	dnsect	DNS Extensions WG
Garden Ballroom 3	OPS	eman	Energy Management WG
Emerald	OPS	mboned	MBONE Deployment WG
Pearl	RAI	siprec	SIP Recording WG
Valley Ballroom C	RTG	ccamp	Common Control and Measurement Plane WG
Garden Ballroom 1	SEC	ipsecme	IP Security Maintenance and Extensions WG

1510-1610 Afternoon Session II

Jade 1	APP	vcarddav	vCard and CardDAV WG
Valley Ballroom A	INT	lwip	Light-Weight IP Protocol Design BOF
Emerald	RAI	mmusic	Multiparty Multimedia Session Control WG
Garden Ballroom 3	RTG	isis	IS-IS for IP Internets WG
Garden Ballroom 1	SEC	emu	EAP Method Update WG
Pearl	SEC	isms	Integrated Security Model for SNMP WG
Valley Ballroom C	TSV	mptcp	Multipath TCP WG

1610-1630 Afternoon Beverage and Snack Break I - Valley Ballroom Foyer

1630-1930 IETF Operations and Administration Plenary - Valley Ballroom ABC

1. Welcome
2. Host Presentation
3. Itojun Service Award
4. Reporting
 - IETF Chair Report
 - NOC Report
 - IAOC Chair & IAD Reports
 - Trust Chair Report
 - NomCom Chair Report
5. Recognition
6. IAOC Open Mic
7. IESG Open Mic

THURSDAY, November 11, 2010

0800-1700 IETF Registration - Valley Ballroom Foyer

0900-1130 Morning Session I

Jade 1	INT	anep	Access Node Control Protocol WG - Moved to Monday afternoon session I 1300-1500
Valley Ballroom A	INT	mif	Multiple Interfaces WG
Emerald	OPS	opsawg	Operations and Management Area Working Group WG
Pearl	RAI	martini	Multiple AoR reachability InformatioN Indication WG
Valley Ballroom C	RTG	mpls	Multiprotocol Label Switching WG
Garden Ballroom 3	RTG	sidr	Secure Inter-Domain Routing WG
Garden Ballroom 1	SEC	abfab	Application Bridging for Federated Access Beyond web WG
Valley Ballroom B	TSV	conex	Congestion Exposure WG

1130-1300 Break

1300-1500 Afternoon Session I

Valley Ballroom C	INT	intarea	Internet Area Working Group WG
Emerald	IRTF	samrg	Scalable Adaptive Multicast Research Group
Jade 1	OPS	bmwg	Benchmarking Methodology WG
Garden Ballroom 3	RAI	avt	Audio/Video Transport WG
Garden Ballroom 1	RTG	idr	Inter-Domain Routing WG
Valley Ballroom A	RTG	roll	Routing Over Low power and Lossy networks WG
Valley Ballroom B	SEC	saag	Security Area Open Meeting
Pearl	TSV	tcpm	TCP Maintenance and Minor Extensions WG

1500-1520 Afternoon Beverage and Snack Break I - Valley Ballroom Foyer

1520-1720 Afternoon Session II

Emerald	APP	decade	Decoupled Application Data Enroute WG
Pearl	INT	dhc	Dynamic Host Configuration WG
Emerald	IRTF	dtmrg	Delay Tolerant Networking Research Group - Moved to Monday afternoon session II 1510-1610
Jade 1	OPS	dime	Diameter Maintenance and Extensions WG
Valley Ballroom C	RAI	dispatch	Dispatch WG
Valley Ballroom A	RTG	l2vpn	Layer 2 Virtual Private Networks WG
Garden Ballroom 3	RTG	manet	Mobile Ad-hoc Networks WG
Garden Ballroom 1	SEC	kidns	Cryptographically Secured Communication by Using Information in DNS BOF
Valley Ballroom B	TSV	behave	Behavior Engineering for Hindrance Avoidance WG

1720-1740 Afternoon Beverage and Snack Break II - Valley Ballroom Foyer

1740-1940 Afternoon Session III

Pearl	INT	dhc	Dynamic Host Configuration WG
Valley Ballroom C	INT	mext	Mobility EXTensions for IPv6 WG
Garden Ballroom 1	INT	pcp	Port Control Protocol WG
Valley Ballroom A	OPS	dnsop	Domain Name System Operations WG
Valley Ballroom B	RAI	sipcore	Session Initiation Protocol Core WG
Garden Ballroom 3	RTG	karp	Keying and Authentication for Routing Protocols WG
Emerald	RTG	pce	Path Computation Element WG
Jade 1	TSV	fecframe	FEC Framework WG

FRIDAY, November 12, 2010

0800-1100 IETF Registration - Valley Ballroom Foyer

0900-1130 Morning Session I

Garden Ballroom 1	INT	armd	Address Resolution for Massive amounts of hosts in one broadcast Domain BOF
Valley Ballroom A	IRTF	VNRG	Virtual Networks Research Group
Valley Ballroom B	OPS	grow	Global Routing Operations WG
Emerald	OPS	radext	RADIUS EXTensions WG
Jade 1	RAI	cuss	Call Control UI Service for SIP WG
Valley Ballroom C	RAI	geopriv	Geographic Location/Privacy WG
Jade 1	RAI	drinks	Data for Reachability of Inter/tra Network SIP WG - Moved to Wednesday morning session I 0900-1130
Pearl	RAI	sipclf	SIP Common Log Format WG - Moved to Tuesday morning session I 0900-1130
Garden Ballroom 3	TSV	ppsp	Peer to Peer Streaming Protocol WG

1130-1300 Break

1300-1400 Afternoon Session I

Garden Ballroom 3	INT	lisp	Locator/ID Separation Protocol WG - Moved to Monday morning session I 0900-1130
Emerald	INT	mip4	Mobility for IPv4 WG
Valley Ballroom A	OPS	v6ops	IPv6 Operations WG
Pearl	RAI	atoca	Authority-to-Citizen Alert WG
Garden Ballroom 1	RTG	rtgwg	Routing Area Working Group WG
Jade 1	SEC	krb-wg	Kerberos WG

1415-1515 Afternoon Session II

Garden Ballroom 3	INT	lisp	Locator/ID Separation Protocol WG - Moved to Monday morning session I 0900-1130
Emerald	INT	mip4	Mobility for IPv4 WG
Valley Ballroom A	OPS	v6ops	IPv6 Operations WG
Pearl	RAI	atoca	Authority-to-Citizen Alert WG
Garden Ballroom 1	RTG	rtgwg	Routing Area Working Group WG
Jade 1	SEC	krb-wg	Kerberos WG

Thank You to IETF 79 Host and Sponsors

Hosts



清华大学
Tsinghua University



中国互联网协会
Internet Society of China

Platinum Sponsors



Gold Sponsor



Silver Sponsor



Special Sponsors



中国移动通信
CHINA MOBILE

Bronze Sponsor



Next Meeting: IETF 80



The banner features a large orange background on the left with a white circle containing the text "IETF PRAHA". Below this, a blue background contains a grid of small, stylized human icons. At the bottom, the dates "27.03 – 01.04 2011" are displayed in orange and blue, with the website "www.ietf80.cz" in white.

IETF 80 – Prague, Czech Republic March 27-April 1, 2011

Sponsored by



Interested in Hosting an IETF?

The IAOC makes decisions about IETF meeting location and venue based on a number of factors, including host preferences, the availability of sponsors, availability and pricing of venues, and more. If you have an idea for a meeting location, or are interested in sponsoring a meeting, please contact Drew Dvorshak at dvorshak@isoc.org.

